

Lot 110 : 4,321 SqFt

Private Alley

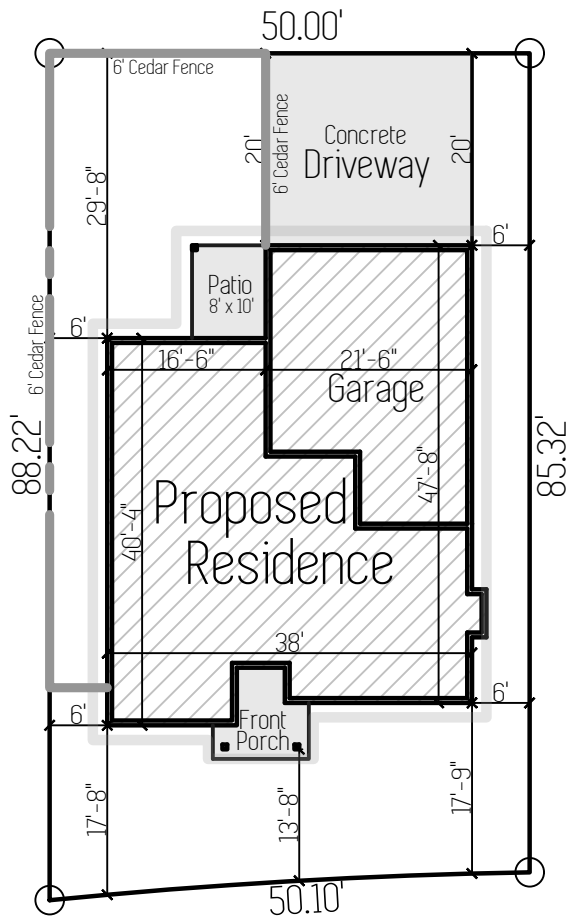

Plan : Hoodview
Living Area : 2,200 SqFt
Garage Area : 550 SqFt
Lot Coverage: 1,788 SqFt (41.4%)

----- Onsdorff Blvd. -----



Site Plan

June 16th 2021

2913 NW Onsdorff Blvd. Battle Ground, WA

Lone Oak Estates, Phase 3, Lot 110

Scale : 1"=20'

