

NW Onsdorff Blvd.

Lot 112 : 5,031 SqFt

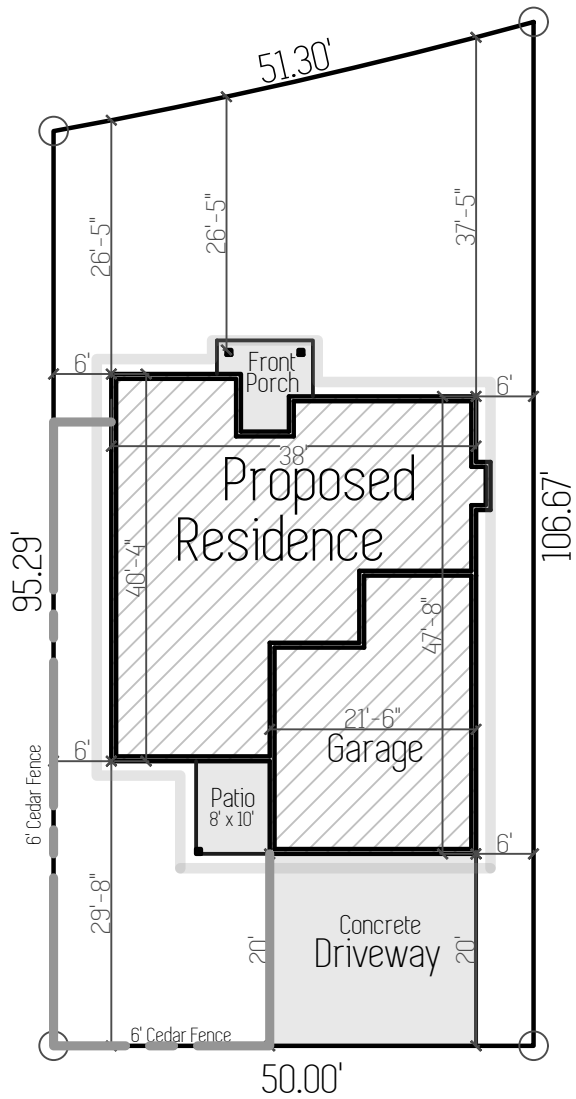

Plan : Hoodview C
 Living Area : 2,200 SqFt
 Garage Area : 550 SqFt
 Lot Coverage: 1,788 SqFt (35.5%)

Private Alley



Site Plan

Apr. 12th 2022

2905 NW Onsdorff Blvd. Battle Ground, WA
 Lone Oak Estates, Phase 3, Lot 112

Scale : 1"=20'

